

N12

MANUAL

BELIEVE IT

www.Antec.com

All rights reserved. Specifications are subject to change without prior notice. Actual products and accessories may differ from illustrations. Omissions and printing errors excepted. Content of delivery might differ in different countries or areas. Some trademarks may be claimed as the property of others.

V2.2

©1986 – 2024 Antec Inc. All rights reserved.

1 CONTENTS

FAN

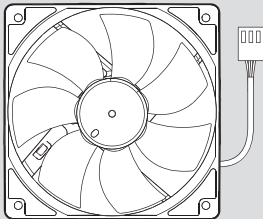

1-TO-3 SPLITTER CABLE

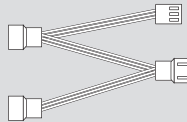

SCREW



2 FAN INTRODUCTION

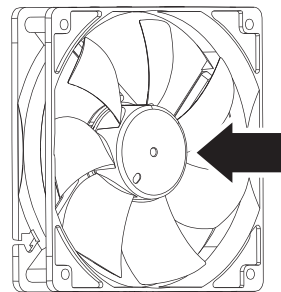

AIR-IN

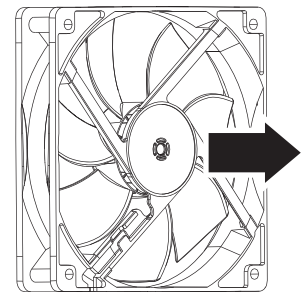

AIR-OUT

3 FAN INSTALLATION

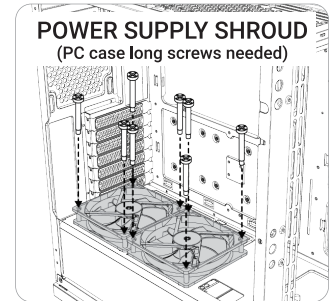
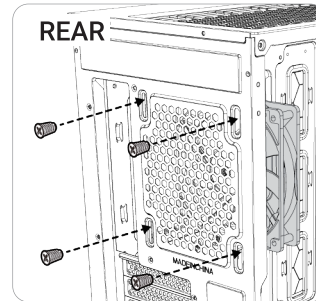
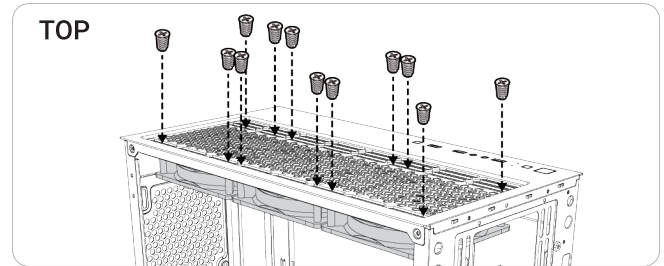
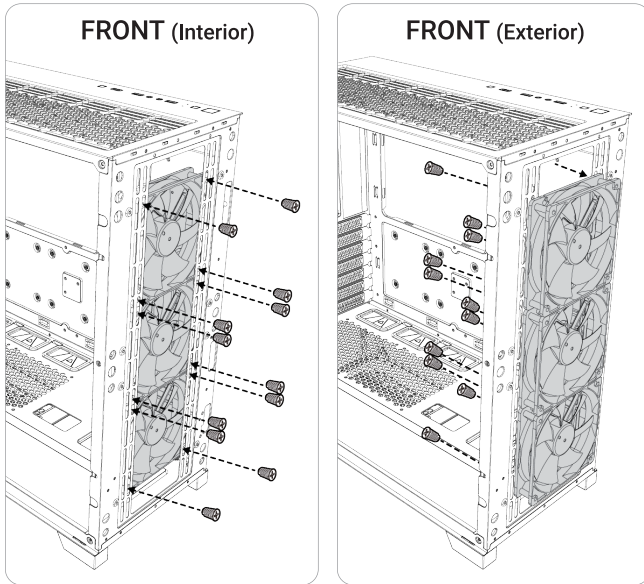

4 FAN CONNECTION

OPTION A :

- Connect the 3-pin connector to the chassis fan header on the motherboard.

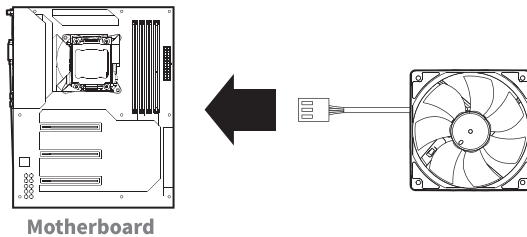

OPTION B :

- Connect the 3-pin connector to the 1-to-3 splitter cable.
- Connect the 1-to-3 splitter cable to the chassis fan header on the motherboard.

